



CLAMPS & WORK HOLDING DEVICES

BASIC CLAMPING ELEMENTS.

TOP CLAMPING SYSTEMS.

CLAMP SUPPORT SYSTEMS

SIDE CLAMPING SYSTEMS.

QUICK ACTING CLAMPING SYSTEMS.

CNC TURNING CENTER ACCESSORIES

INJECTION MOULD MACHINE CLAMPING SYSTEMS.



INDUSTRIAL TOOLS & HARDWARE

Group-V: Quick acting clamping systems.



- Adjustable Height clamp.
- Up-Thrust clamp.
- Low Height clamp.
- Spring Plunger.
- Quick acting element.
- Fixture Eye Bolt

Adjustable Height Clamp.



- Rapid clamping with Downward thrust.
- Quick Clamping with down thrust by means of precision threaded spindle and eccentric lever.
- 360 degree swing of clamping pad as well as any position of toggle arm is possible; hence job can be removed and placed instantly.
- Compact construction. Increase clamping height by using extra height cylinders. Used as standardized fast clamping elements in fixtures, pallets of CNC milling.

APPLICATIONS

- Used as standardized fast clamping elements in fixtures, pallets of CNC milling.

Item code	Name	L	D	H1	H2	wt. in kgs
aec1501.101	AHC-70	35	40	70	105	1.430
aec1501.102	AHC-100	35	40	100	135	1.700
aec1501.111	AC-35	35	40	-	-	0.320
aec1501.112	AC-70	70	40	-	-	0.640

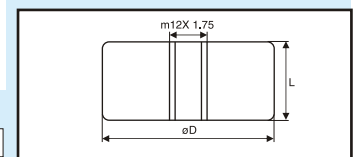
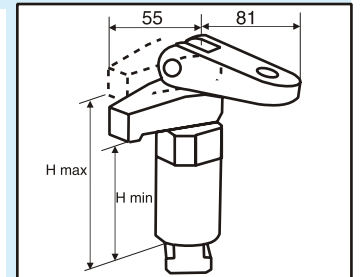

Up Thrust Clamp



- Rigid clamping with up ward thrust.
- Specially designed for clamping work pieces which have already machined on one side and have to be further machined with machined side as reference.
- Quick upward clamping from bottom by means of a precision threaded spindle and eccentric lever. Parallelism and other accuracies are positively achieved by maintaining all dimensions within precise tolerances.
- Easy and rapid clamping & declamping is achieved by swinging clamping arm.

APPLICATIONS

- Used as standardized fast clamping elements in fixtures, pallets of CNC milling.

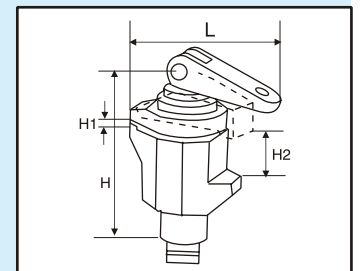

Item code	Name	L	B	H	H1(min)	H1(max)	H2(min)	H2(max)	Clamping force
aec1502.001	UTC-70	126	95	143	0	35	35	70	600 kgs.

Low Height Clamp



- For Efficient production of medium to small parts.
- Low profile of the clamp permits machining of the job over area without moving the clamp.
- Rapid clamping and release by swift action of the lever.
- Firm clamping of the job by the downward and forward actions of the jaw.

APPLICATIONS:

- Suitable for drilling light milling & cutting operations.

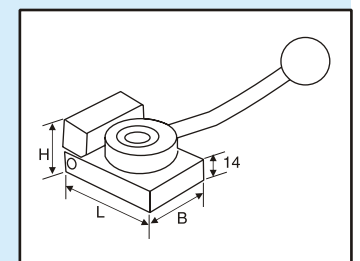

Item Code	Name	L	B	H	Travel	wt. in kgs
aec1503.001	LHC-100	70	48	30	3.0	0.400

Spring Plunger

With rounded plunger pin and internal hexagon.

Blackodised steel body, hardened & blackodised plunger pin, stainless steel spring



Item Code	A	B	C	D	E
aec1504.004	M4	1.8	9	1.5	2.0
aec1504.005	M5	2.4	14	2.0	2.5
aec1504.006	M6	2.7	15	2.0	3.0
aec1504.008	M8	3.8	18	2.0	4.0
aec1504.010	M10	4.5	23	2.5	5.0
aec1504.012	M12	6.2	26	3.5	6.0
aec1504.016	M16	8.5	33	4.5	8.0
aec1504.020	M20	10.0	43	6.5	10.0
aec1504.024	M24	13.4	48	8.0	12.0

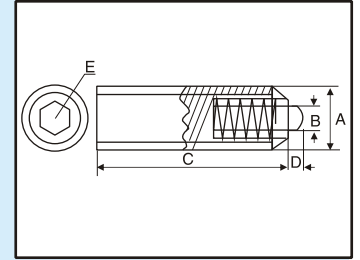

Spring Plunger

With ball and internal hexagon.

Blackodised steel body, hardened ball, stainless steel spring



Item Code	A	B	C	D	E
aec1505.004	M04	2.5	9	0.8	2.0
aec1505.005	M05	3.0	14	0.9	2.5
aec1505.006	M06	3.5	15	1.0	3.0
aec1505.008	M08	4.5	18	1.5	4.0
aec1505.010	M10	6.0	23	2.0	5.0
aec1505.012	M12	8.0	26	2.5	6.0
aec1505.016	M16	10.0	33	3.5	8.0
aec1505.020	M20	12.0	43	4.5	10.0
aec1505.024	M24	15.0	48	5.5	12.0

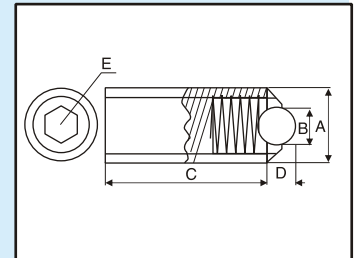

Quick Acting Element

Instant clamping elements to build your own Jigs & fixtures



- Fast clamping & de-clamping just by rotating handle 90°.
- Available in foot and bracket mounted types.
- Increases productivity of your jigs & fixtures by saving in clamping time.
- Precision machine from high tensile spheroidal graphite cast iron for long life.

APPLICATIONS

- Used in construction of fixtures for fast clamping & de-clamping.
- Can be used independently as vice on low & medium cutting applications.

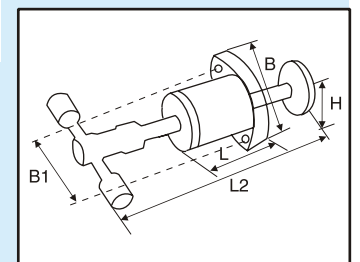
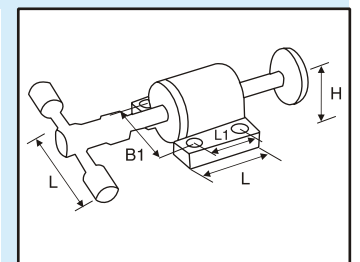

Item Code	Name	L	L1	L2	B	B1	H	Travel	Force (Kg.)	wt. in kgs
aec1506.001	QEF-100	74	45	225	100	75	28.5	108	400	2.1
aec1506.002	QEB-100	63	-	225	96	82	28	108	400	1.7

Fixture Eye Bolt



Item code	D	d	d1	S	L	L1	gm
aec1507.080	M8	8.0	18	9	75	35	38
aec1507.100	M10	10.0	20	12	75	35	55
aec1507.120	M12	12.0	25	14	100	35	100
aec1507.121	M12	12.0	25	14	120	35	124
aec1507.160	M16	16.0	32	17	160	35	275
aec1507.200	M20	20.0	40	21	160	35	395

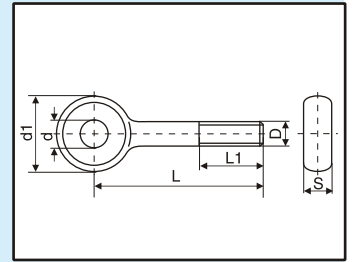

* All dimensions are in mm unless otherwise specified.

* Due to constant development & enhancement in designs, dimensions given in catalogue may change without prior notice.

INDUSTRIAL TOOLS & HARDWARE

OFFICE : PLOT NO.2 DHANALAXMI HSG. SOC. ANANDNAGAR, HINGANE (KH)PUNE 411 051
TELFAX : 24352114, PHONE : 65221812, 64701793 E-mail:- ith_clampings@vsnl.net